

AUSTRALIA

INSTALLATION GUIDE

SMARTVIEW™

Digital Thermostatic Shower Mixer

FD-SVCSMCA

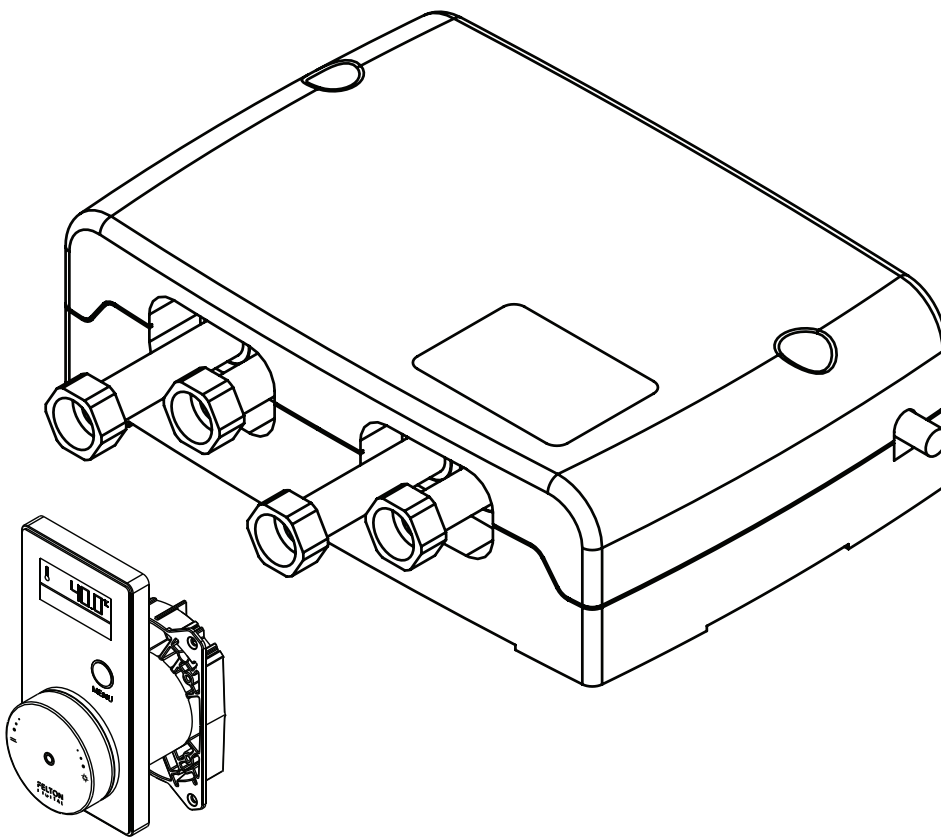

FELTON
DIGITAL

CONTENT

Notice	5
Measurements	5
Scope of delivery	6
Tools required	6
Scope of application	7
Vision wheel interface pre-line installation	8
TLC 30 FTD installation	9
Vision wheel interface final fit installation	14
Operational test	19
Troubleshooting	20
Warranty	21
Processor template	23

NOTICE

PLEASE READ THE MANUAL CAREFULLY BEFORE STARTING THE INSTALLATION. AFTER COMMISSIONING AND TESTING THE SYSTEMS FUNCTIONALITY, THIS DOCUMENT MUST BE GIVEN TO THE END USER OF THE SYSTEM.

PRODUCT TO BE DISCONNECTED BEFORE LINE TEST

In case of a power cut, the unit will remain inactive until the power is back on.

GENERAL

This installation manual contains instructions for the correct installation of the **Smartview™** product. The warranty will be invalidated if the product is not installed according to these instructions.

Installation must be carried out by qualified installers in accordance to this installation manual. Country-specific standards, rules and safety regulation do apply.

PLACE OF INSTALLATION

The **Smartview™** product must be installed in an accessible place and in accordance to this installation manual. This ensures a problem-free service and maintenance procedure.

DANGER OF ELECTRIC SHOCK!

ELECTRICAL INSTALLATION

Before opening the housing, the mains connection must be switched off. Work on electrical parts and connections must be carried out by qualified electrician. Country-specific standards and regulations do apply.

MAINTENANCE

Felton Digital products are made of high quality materials and require only minimal maintenance. The following maintenance tips help to preserve the surface and prevent damage through incorrect cleaning. Fittings and control parts should be wiped dry after used. Only use mild cleaning products that contain soap. The following must not be used: Scourers, abrasive sponges, hydrochloric acid, lime-, plaster- or cement removers, solutions or cleaning agents containing acid ($\text{pH} \leq 4$), lime scale remover or vinegar-based cleaner – and cleaning agents where the chemical solution is not known which may be sold as special cleaner for fittings.

WATER PATH

Input	2× 1/2" BSP female
Output	2× 1/2" BSP female
Flow	max. 36 l/min at 300kPa
Pressure range	Min 150kPa - Max 500kPa
Difference of pressure	Max. 100 kPa/14.5psi
Maximum outlet temperature	45°C
Hot inlet temp range	55°C - 85°C
Cold inlet temp range	5°C - 25°C

ELECTRONICS

Power supply	100-240V AC/50–60 Hz
Power consumption Standby	< 0.5W, max. 45W



MEASUREMENTS

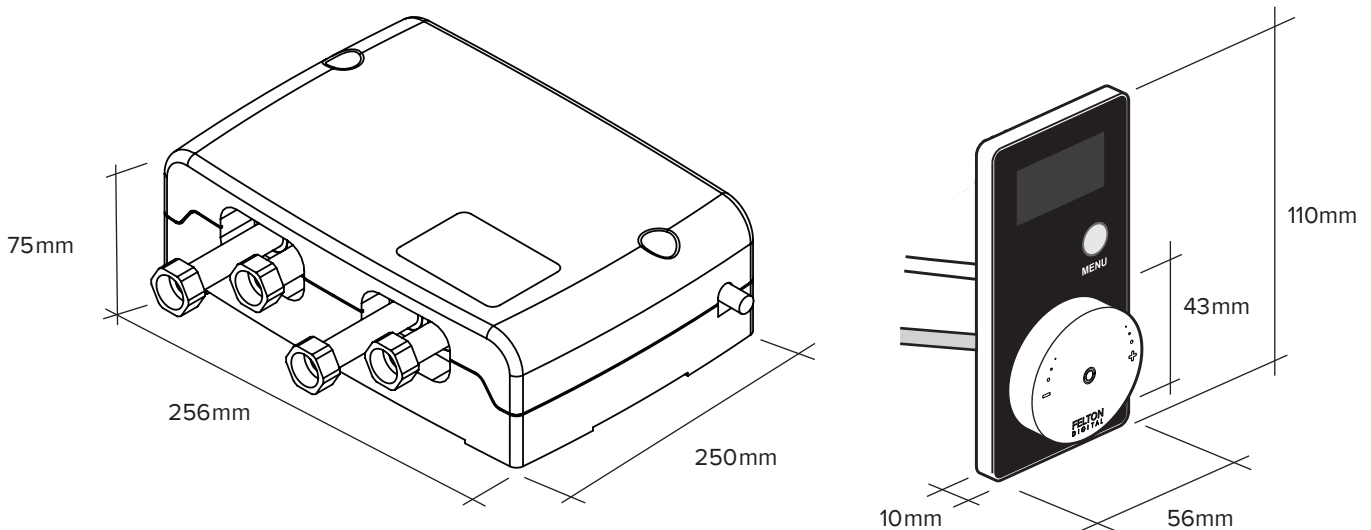

BOX 1 TLC 30 FTD VISION SHOWER

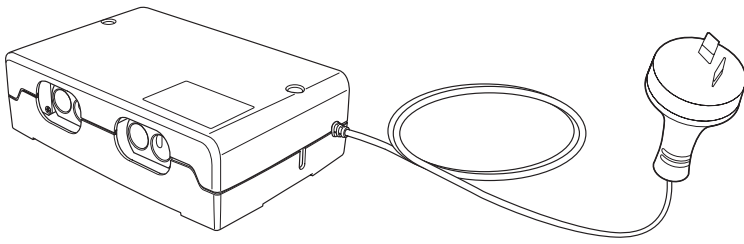

1. TLC 30 FTD

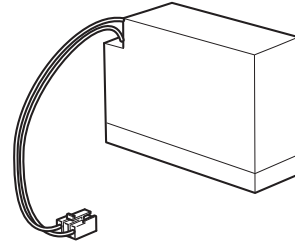

2. Back Up Battery

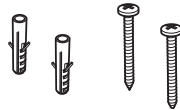

3. Set of screws
2x5x50mm

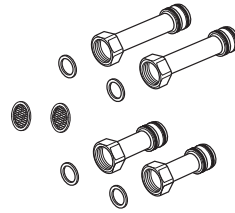

4. Connecting adapter

BOX 2 VISION WHEEL INTERFACE

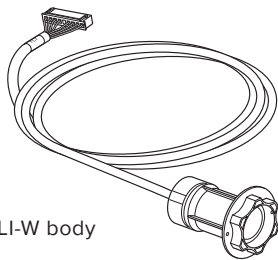

1. TLI-W body

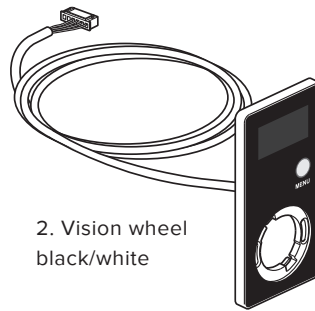

2. Vision wheel
black/white

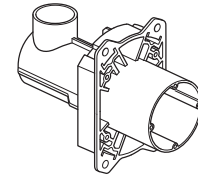

3. In-wall box

4. Fastening
& seal Kit

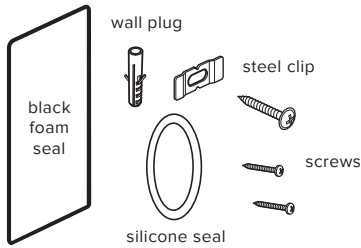

5. Set of screws
6x2.5x16mm

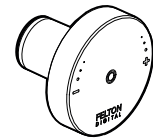

6. TLI-W knob

TOOLS REQUIRED



1. Pencil

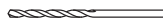

2. Drill bit \varnothing 8 mm

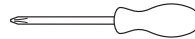

3. Crosshead screwdriver

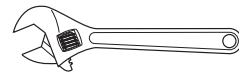

4. Spanner

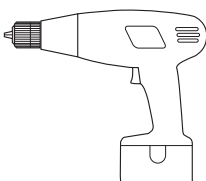

5. Drill

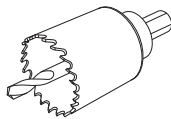

6. 70mm holesaw

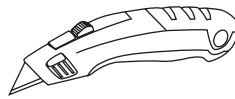

7. Utility knife

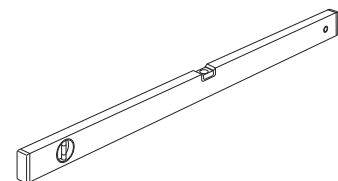

8. Spirit level

SCOPE OF APPLICATION

A Ceiling Mounted Shower handset (Recommended)

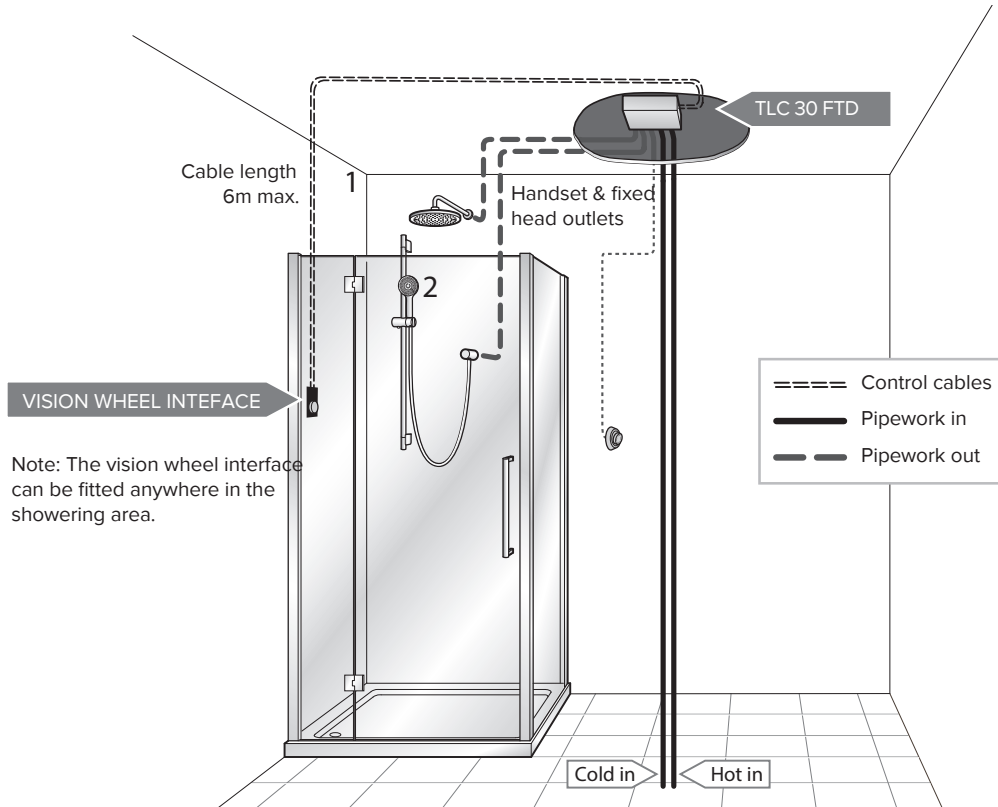

B Wall Mounted Shower handset

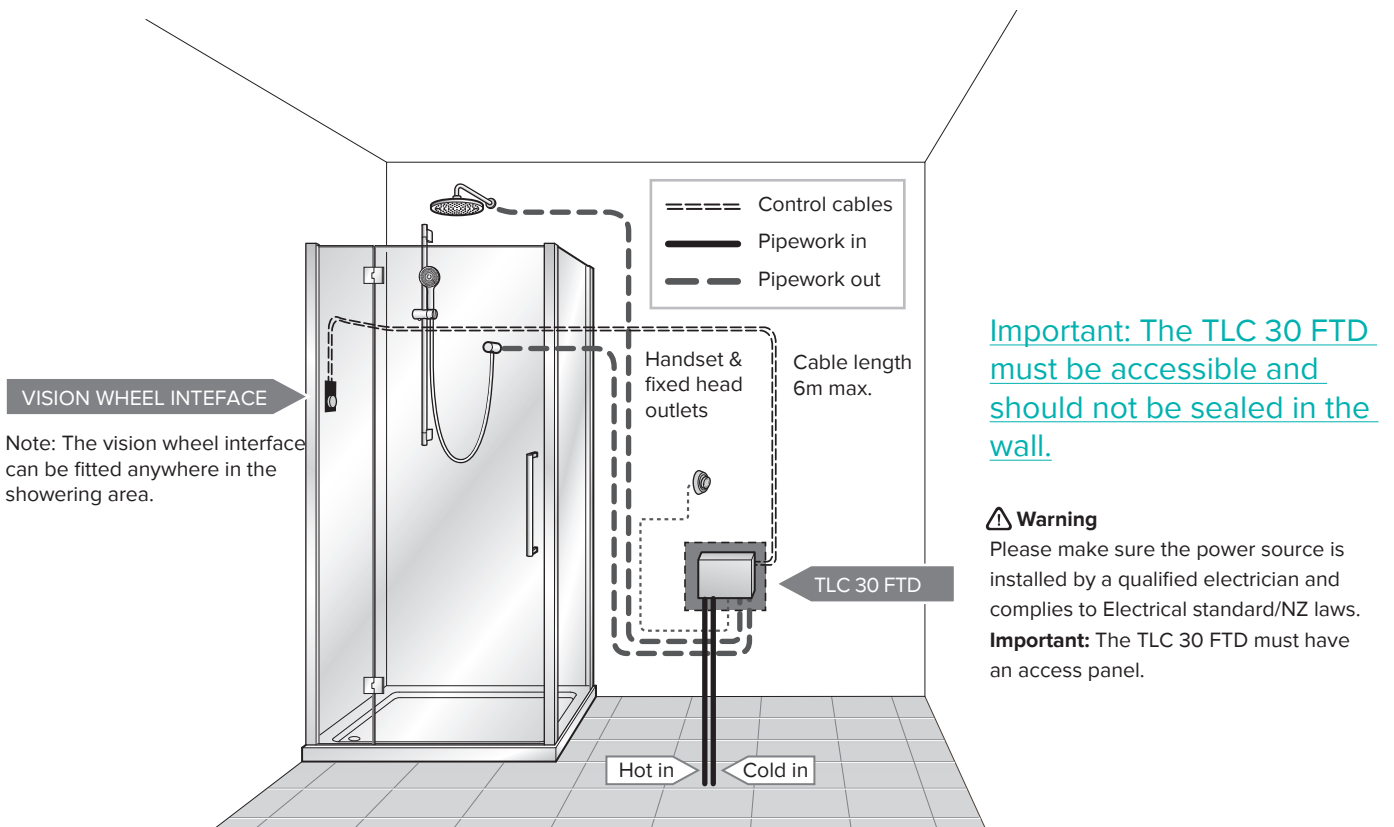

VISION WHEEL INTERFACE PRE-LINE INSTALLATION

1 Cutting down the in-wall box (OPTIONAL)

NOTE: We recommend the in-wall box is cut down as shown using a hacksaw

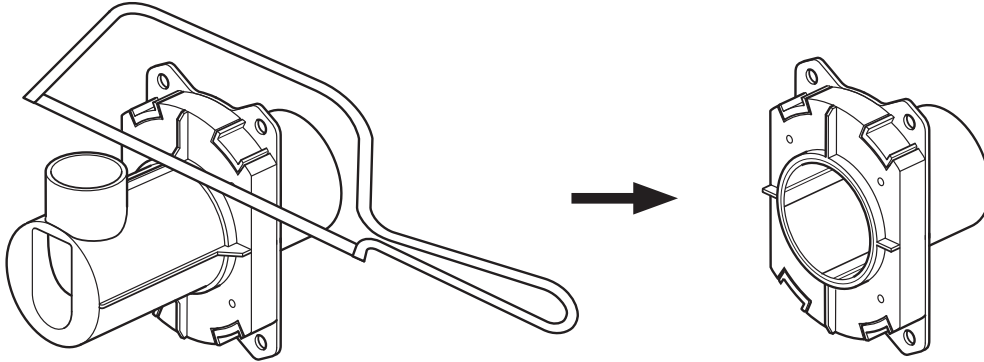

2 Attaching the in-wall box

Prepare the wall to take the in-wall box. The installation of the in-wall box will depend on each individual situation. **In-wall box attached from the front: a 70mm diameter hole is required in a fixing nog flush with face of the timber framing. Conduits should be used in the walls where necessary to protect the cables and allow maintenance.** Attach the in-wall box using the screws supplied.

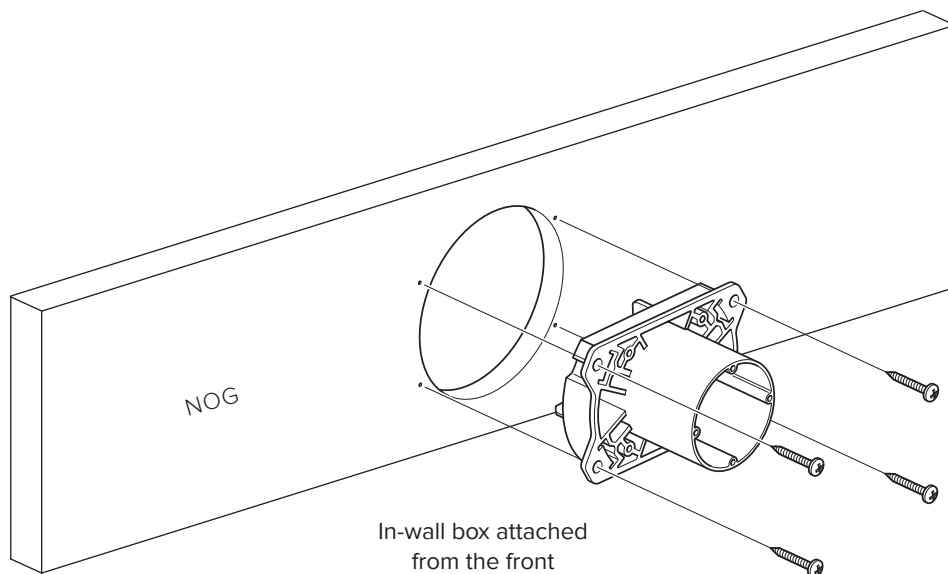

3 Draw wire through in-wall box

The draw wire should be fitted before the wall is lined.

NOTE: Feeding a string or wire through the in-wall box and conduit will make it easier to pull the cables through to the TLC 30 FTD.

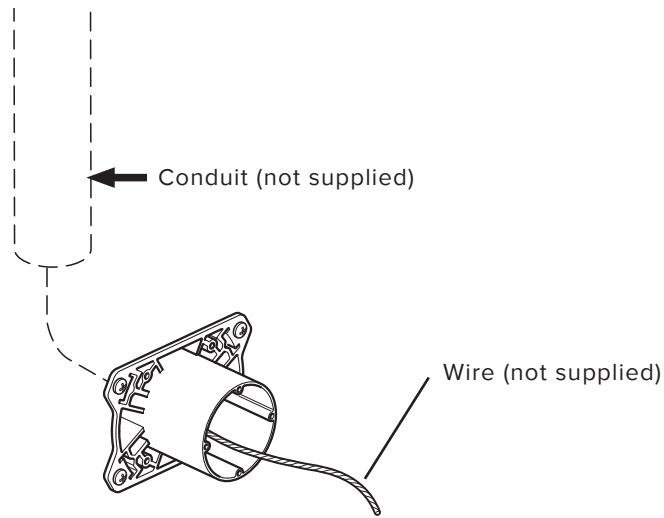

TLC 30 FTD INSTALLATION

4 Remove cover

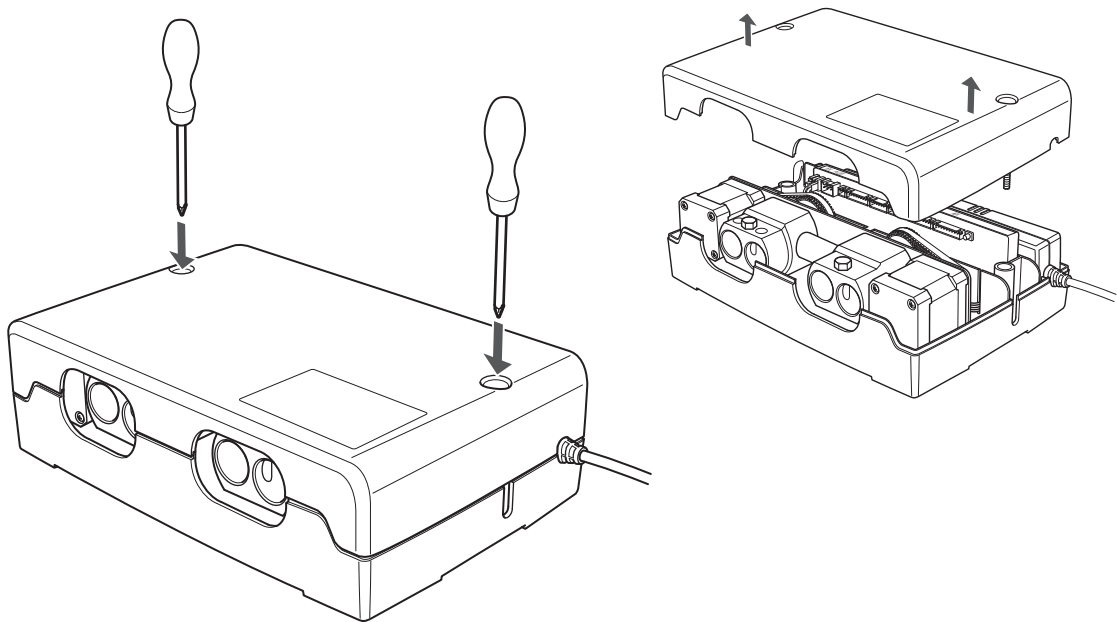

5 Inside TLC 30 FTD

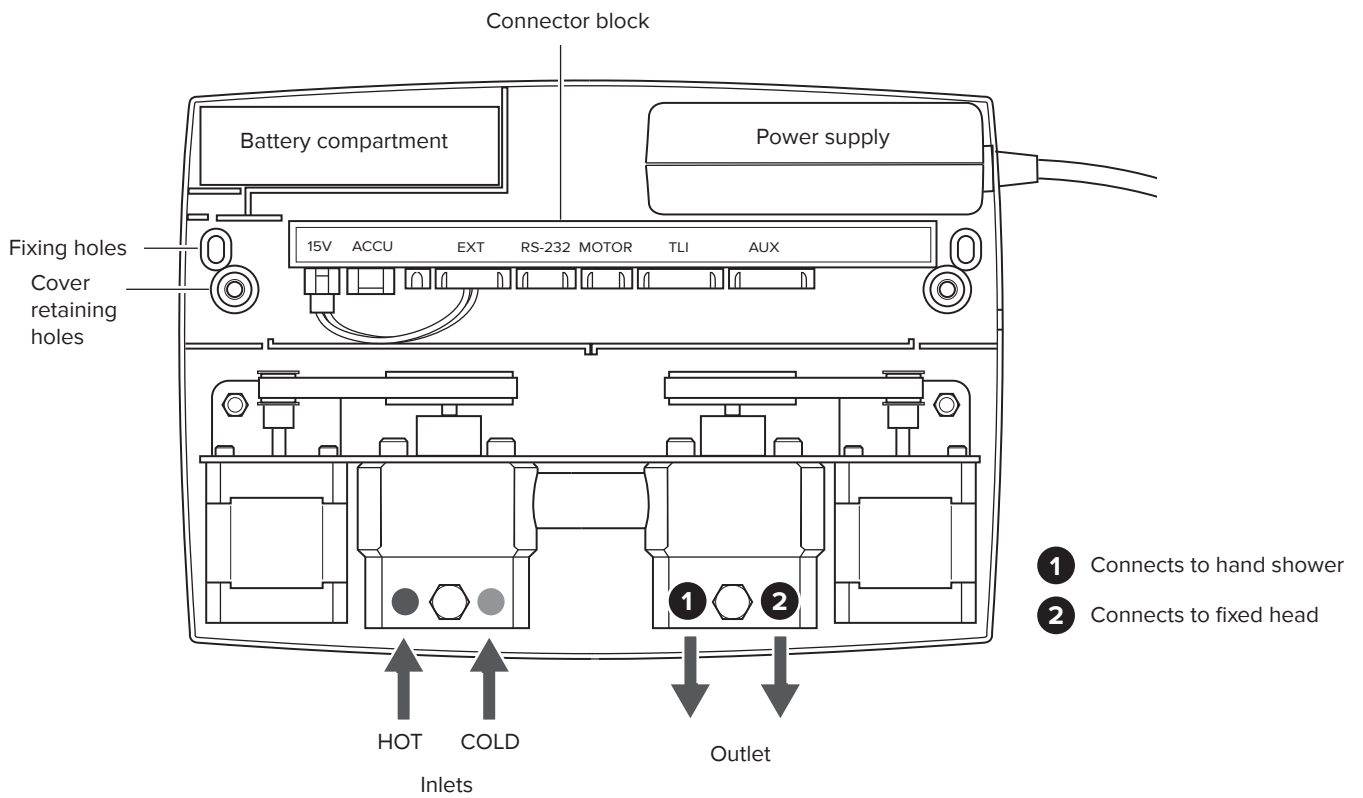

MOUNTING OPTIONS

6 Mark the position of the TLC 30 FTD fixing holes in the selected location

ORIENTATION FOR WALL SITUATION:

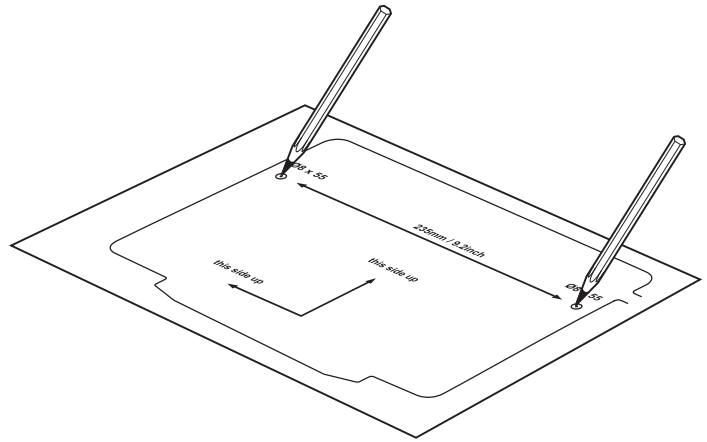
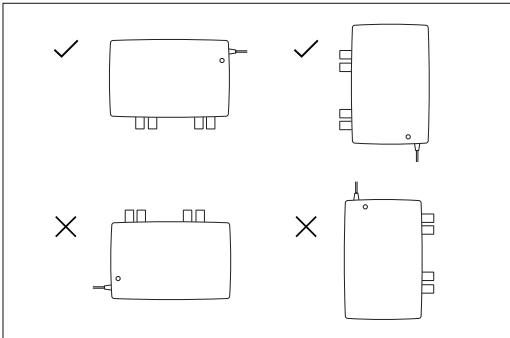

Important: The location of the TLC 30 FTD must be accessible and dry. Use the processor template on the last page to mark the position of the fixing holes in the selected location.

MOUNTING FOR NOG (RECOMMENDED)

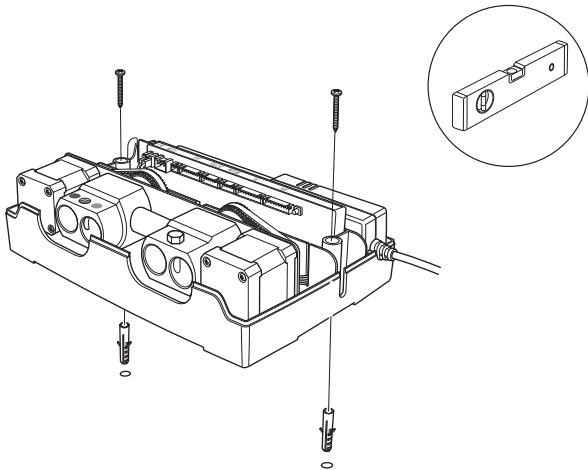

1 Install TLC TLC 30 FTD

MOUNTING FOR CONCRETE

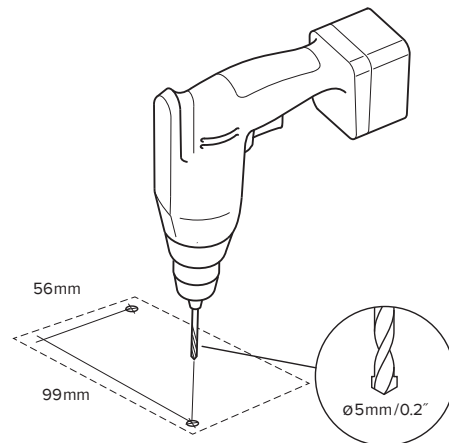

1 Drill fixing holes

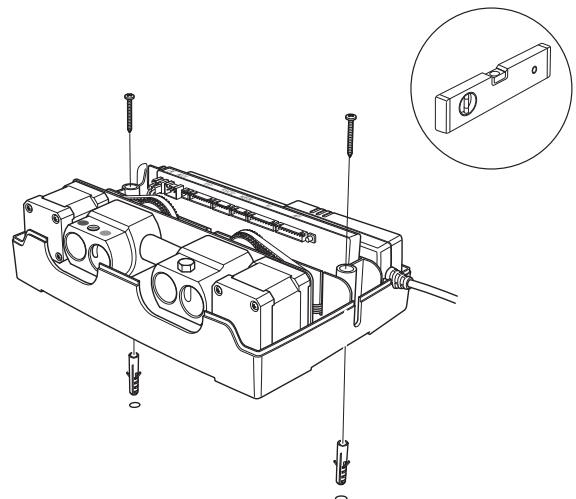

2 Install TLC 30 FTD

7 Remove inlet adapter retaining bolt

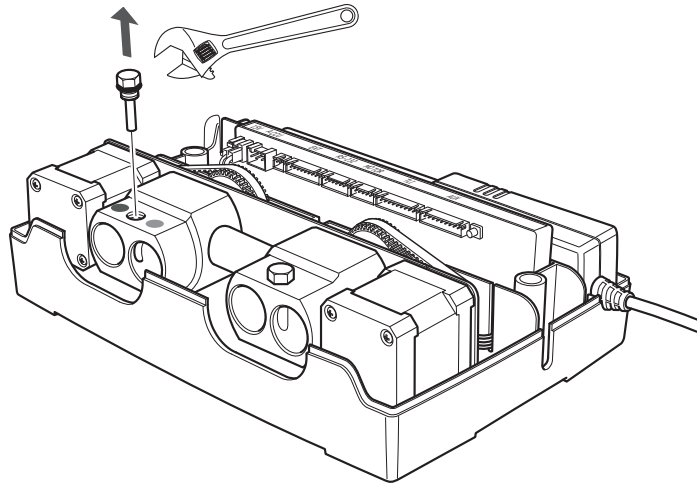

8 Connect hot and cold water supply

Fully insert the inlet adapter into the inlet valves (one long and one short adapter).

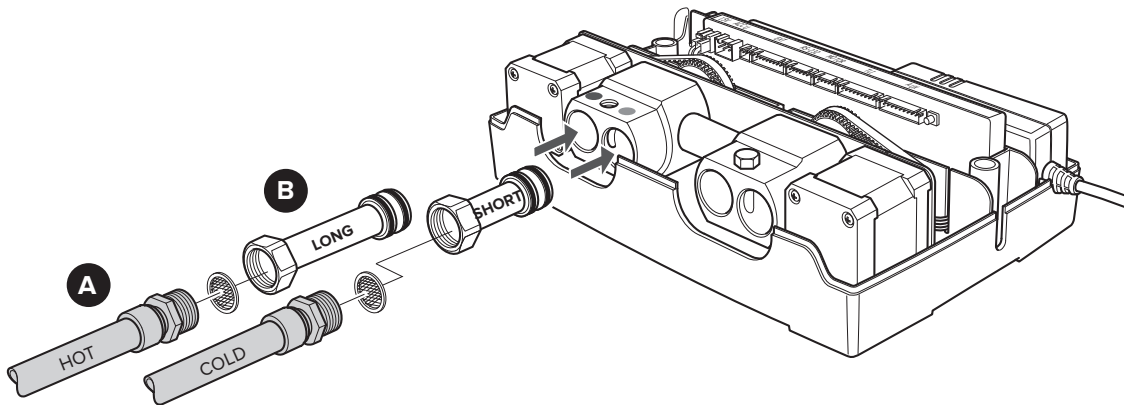

- A** Connect hot and cold water supply
- B** Insert inlet supply

! **IMPORTANT:** Flush the pipework before connection

9 Tighten adapter retaining bolt

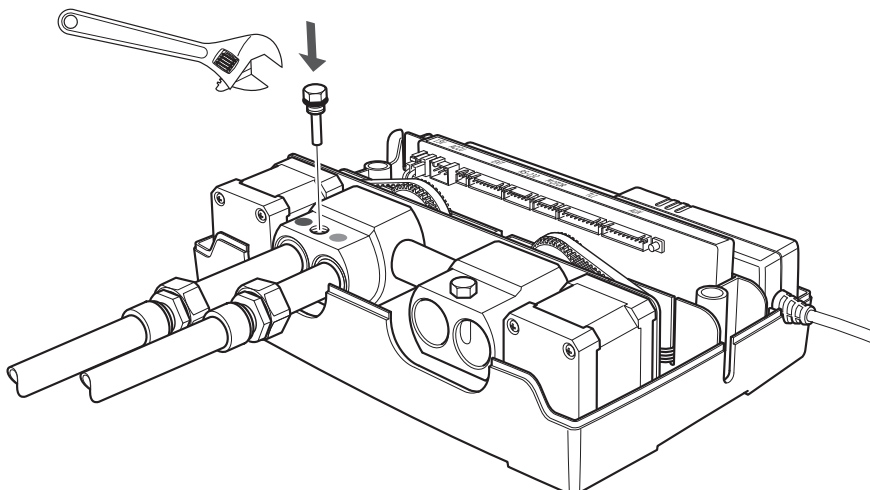

10 Remove outlet adapter retaining bolts

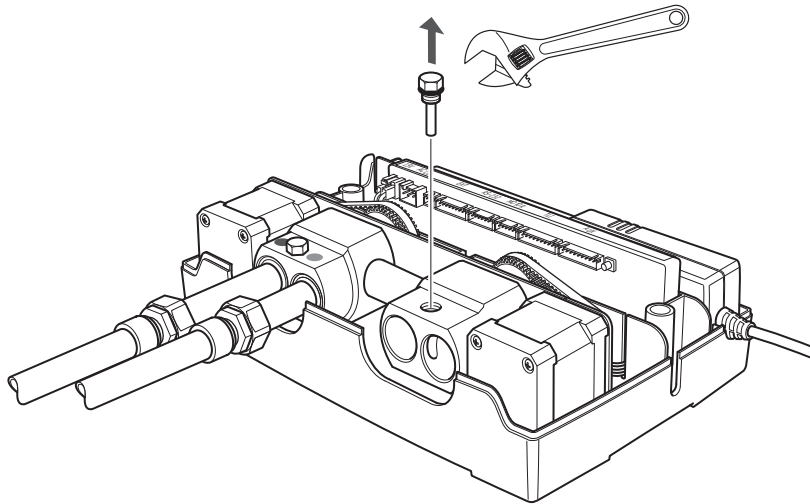

11 Connect outlet pipeworks

Insert outlet adapters and connect outlet pipeworks

If using two outlets:

Connect outlet **1** and outlet **2**

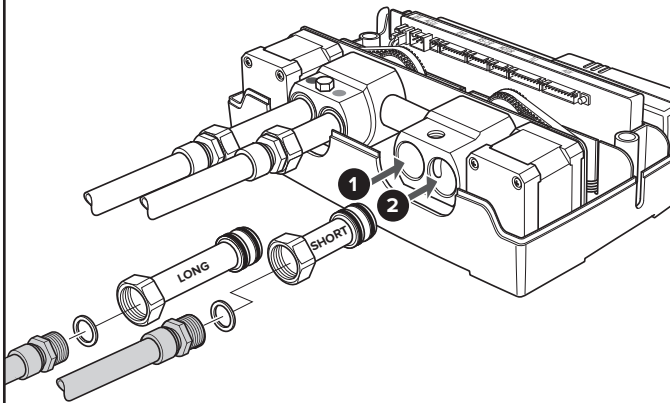

If only using single outlet:

Outlet **1** to be connected.

Outlet **2** to be plugged and sealed.

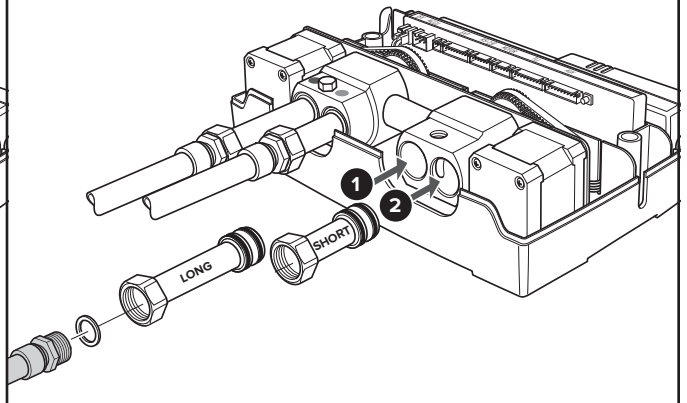

- 1** Primary outlet (Hand Shower)
- 2** Secondary outlet (Fixed Head)

12 Tighten adapter retaining bolt

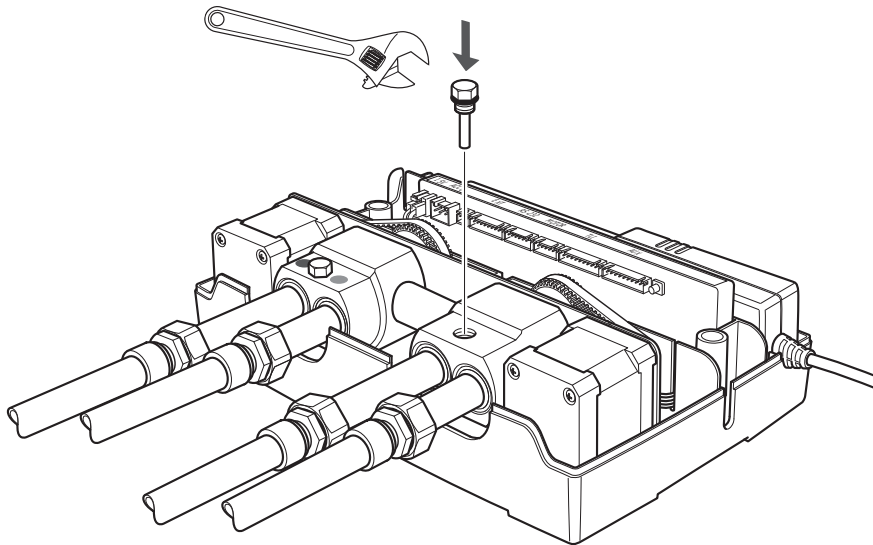

VISION WHEEL INTERFACE FINAL FIT INSTALLATION

13 Fit off after final wall lining is installed

Finish the wall by tiling etc.

40mm diameter holes should be drilled in the tile etc to finish.

Draw a line around the collar, **flush** with the wall. Cut down the collar as marked.

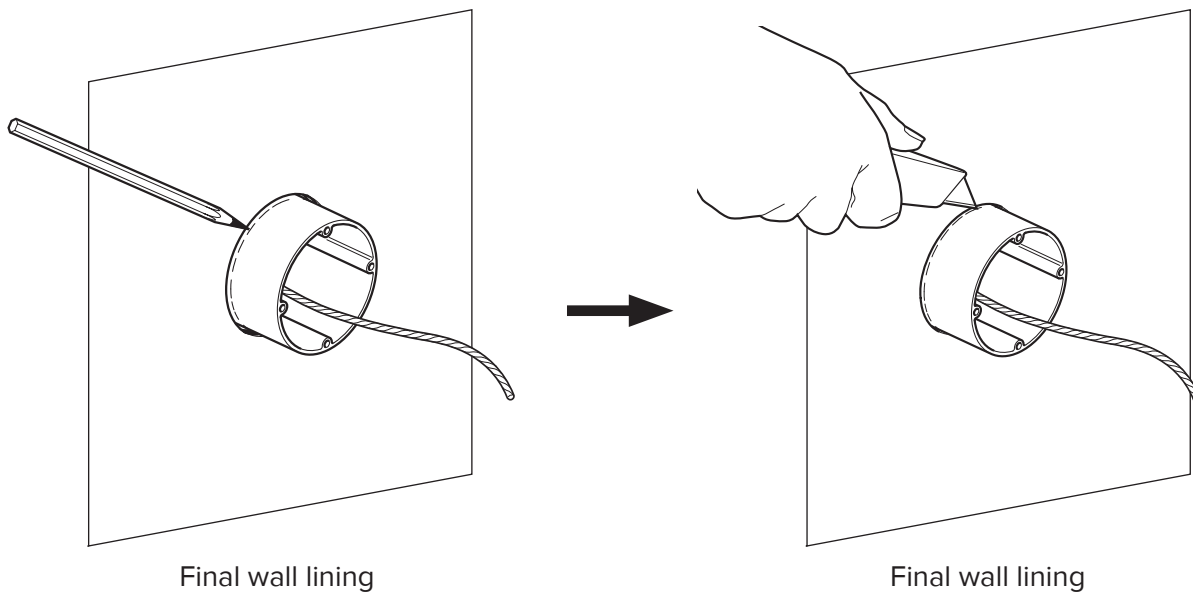

14 Attach steel clip

Fix the control steel clip to the wall where shown using the fixings supplied.

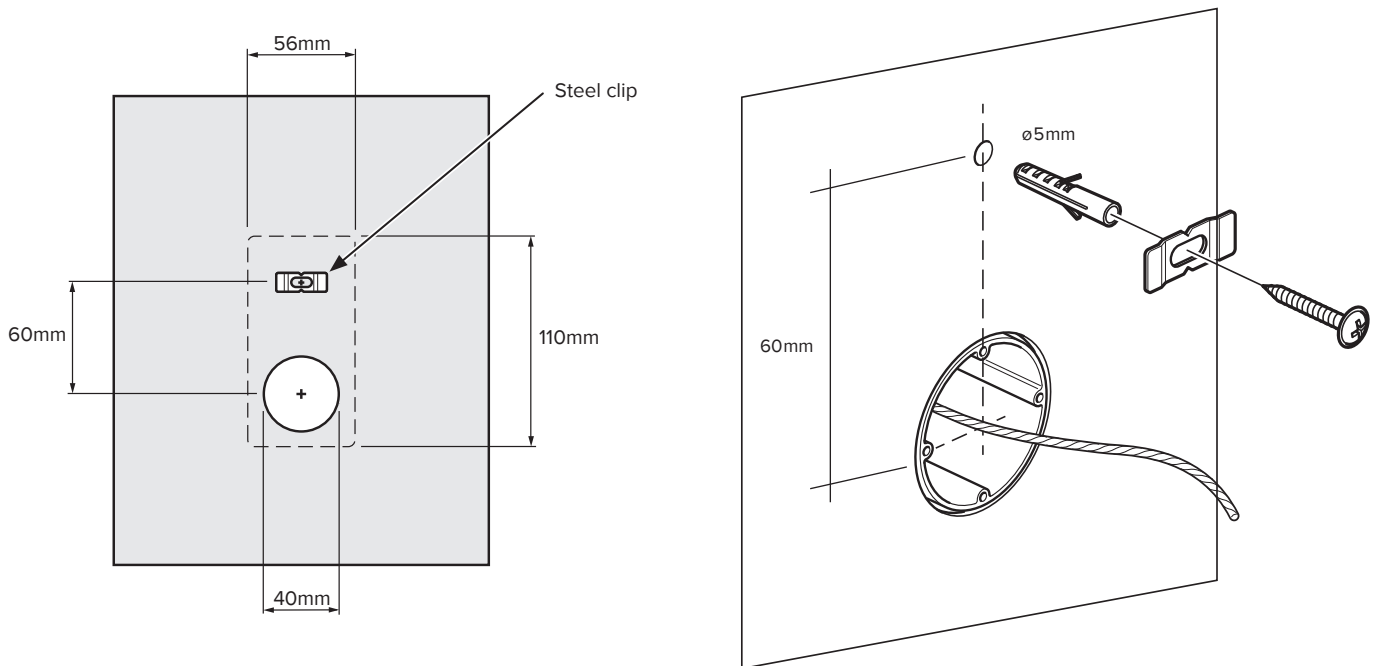

15 Feed both cables through to TLC 30 FTD

- A** Remove TLI-W knob from the TLI-W body. Feed data cable through silicone seal **B** and black foam seal **C**
- D** Secure both cables to the previously installed draw wire and pull the cables to the TLC 30 FTD.

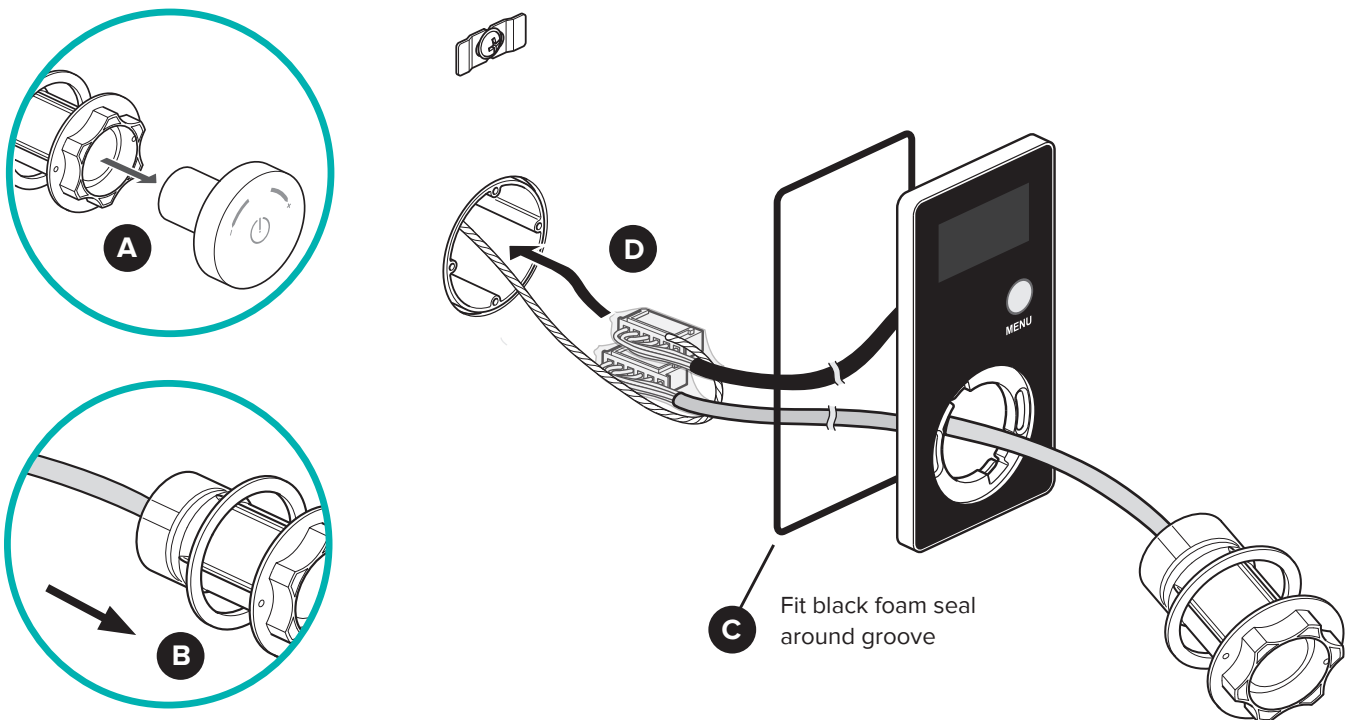

16 Position vision wheel interface and attach in screws

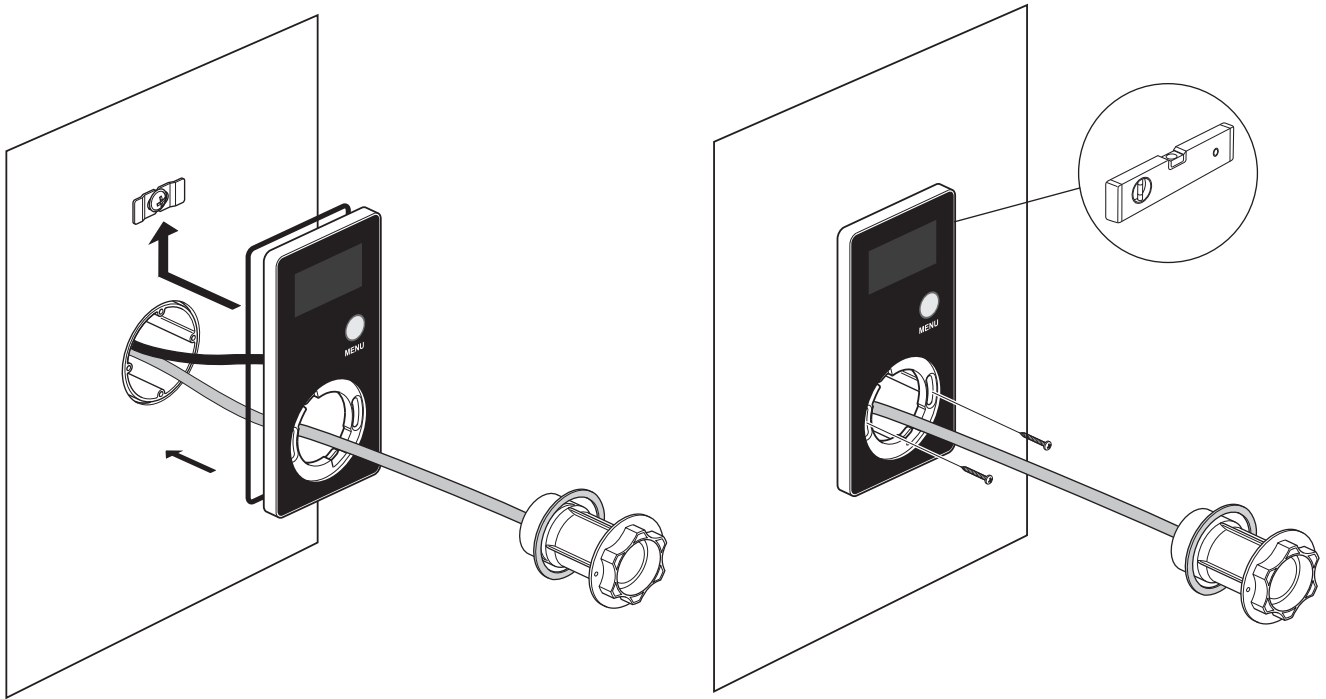

17 Position TLI-W body into the vision wheel interface and lock by turning clockwise.

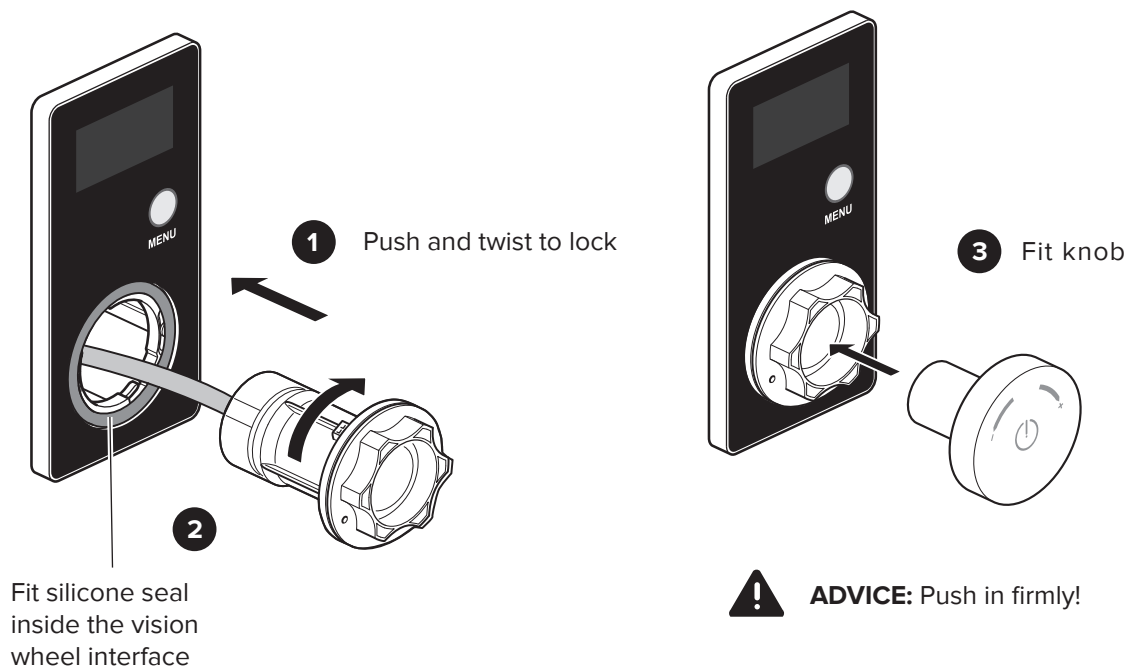

18 Connect back up battery

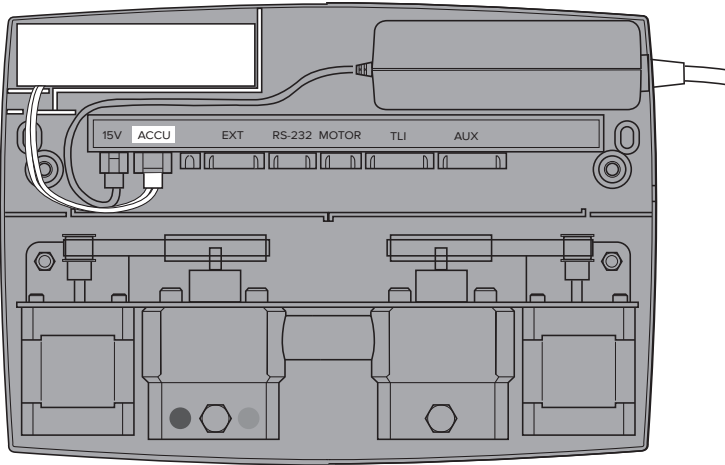

Place back up battery in shown location within TLC 30 FTD and connect cable to ACCU port.

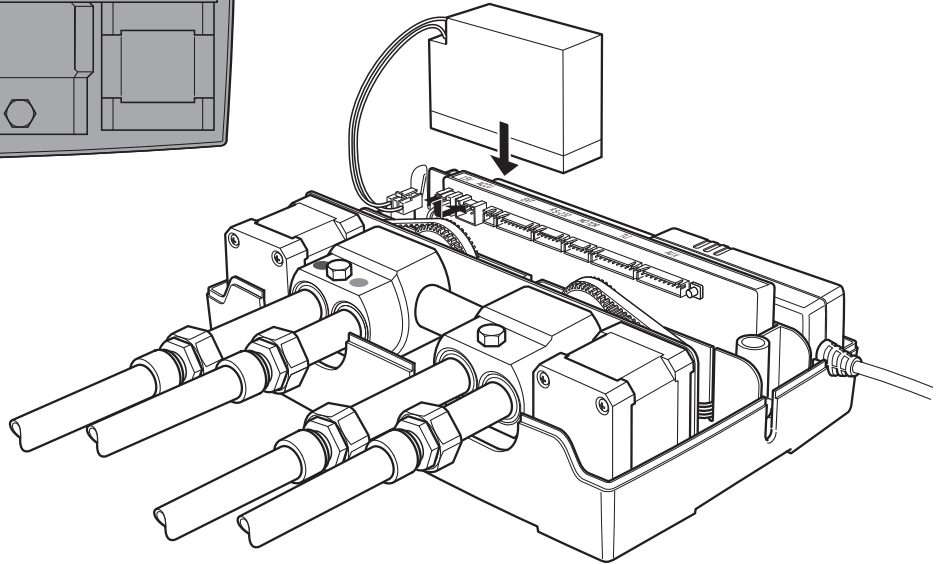

Note: After installation, battery may require 24 hours of charging on mains power before battery back up function before fully operational. Charging occurs once unit is on mains power.

19 Connect TLI-W body to TLI port

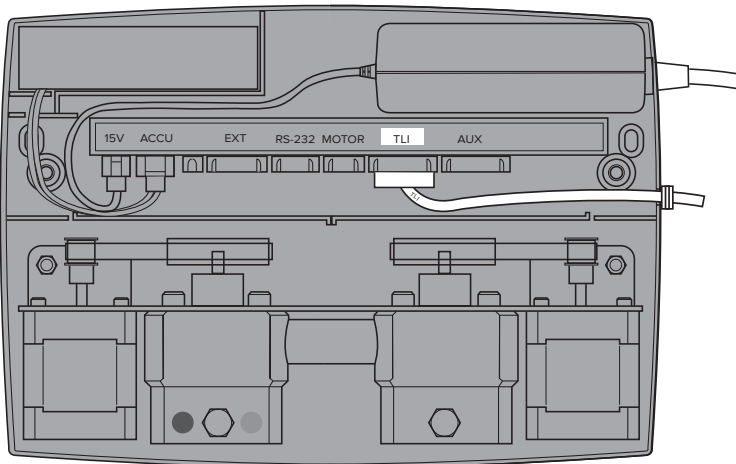

**TLI-W BODY
GREY CABLE**

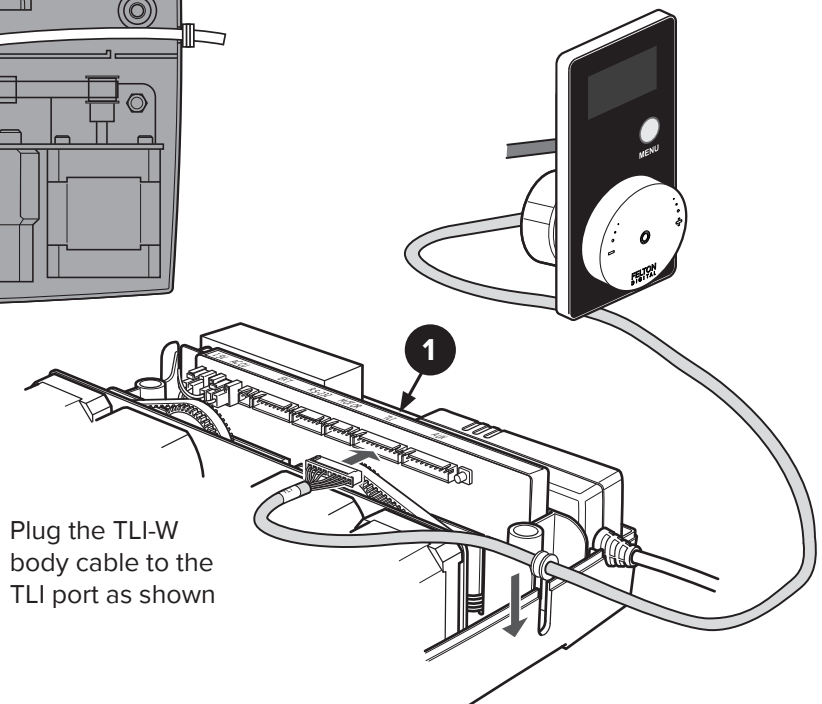

Plug the TLI-W body cable to the TLI port as shown

20 Connect vision wheel interface to RS-232 port

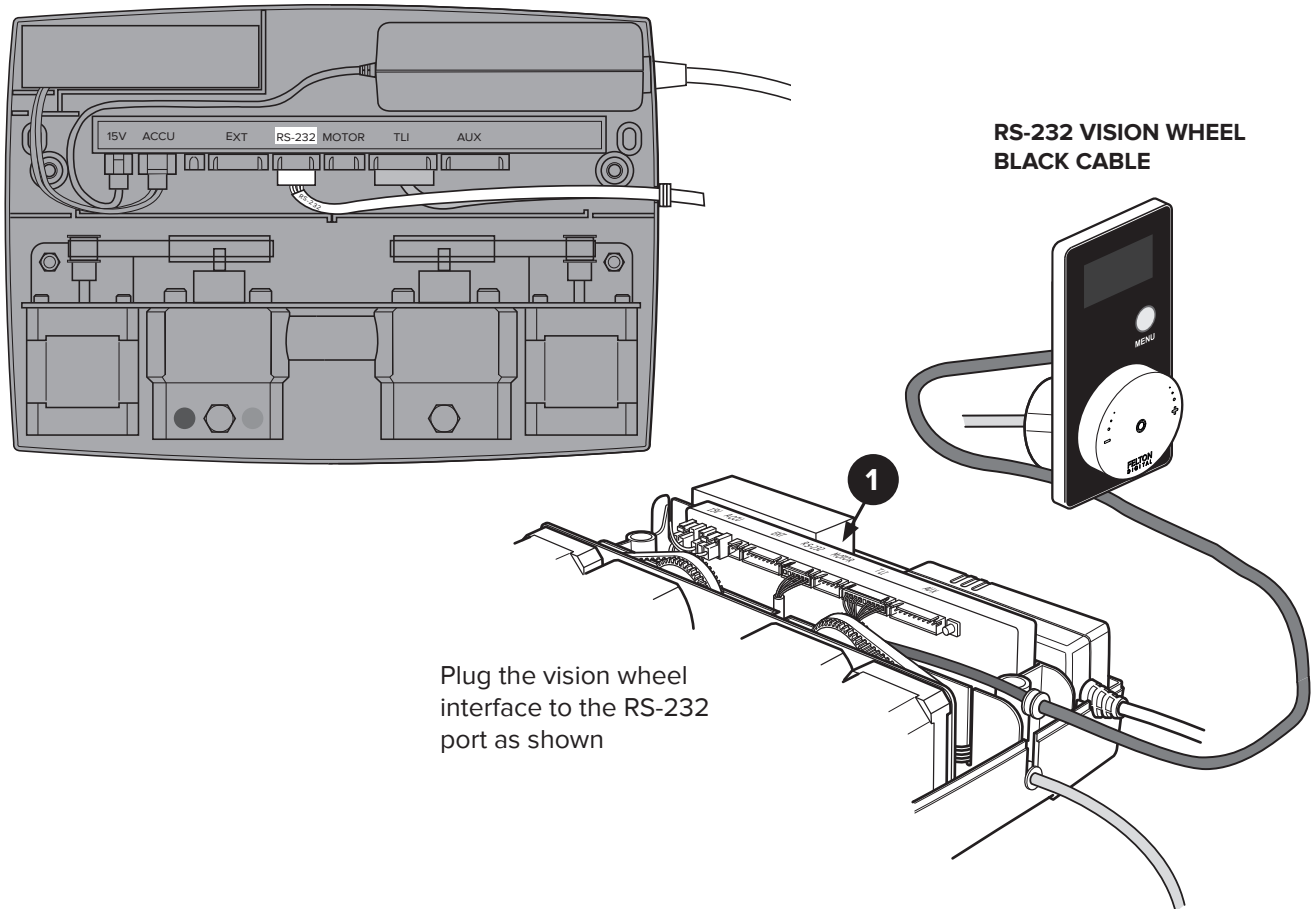

21 Re-fit cover and connect TLC 30 FTD to the mains

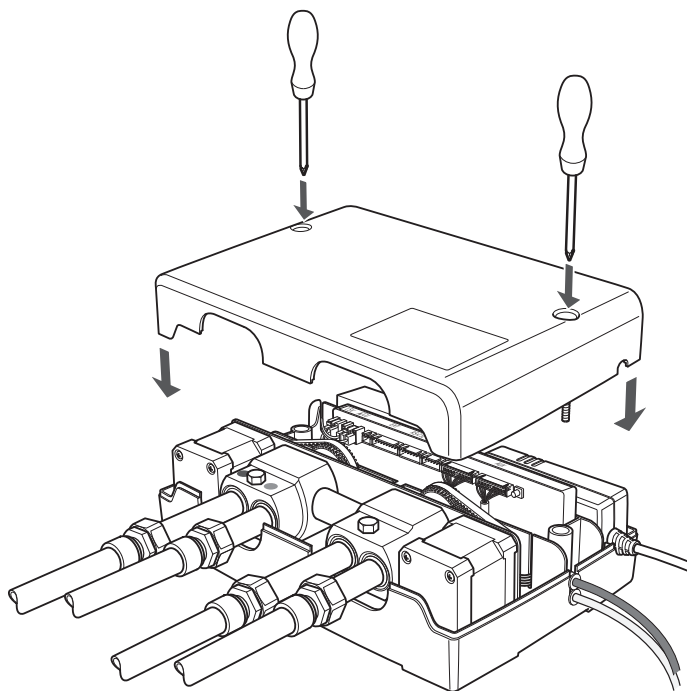



⚡ IMPORTANT: Electrical supply must be installed by a qualified electrician.

OPERATIONAL TESTING:

- 1 Ensure that the TLC 30 FTD is installed correctly and connected to the power supply.

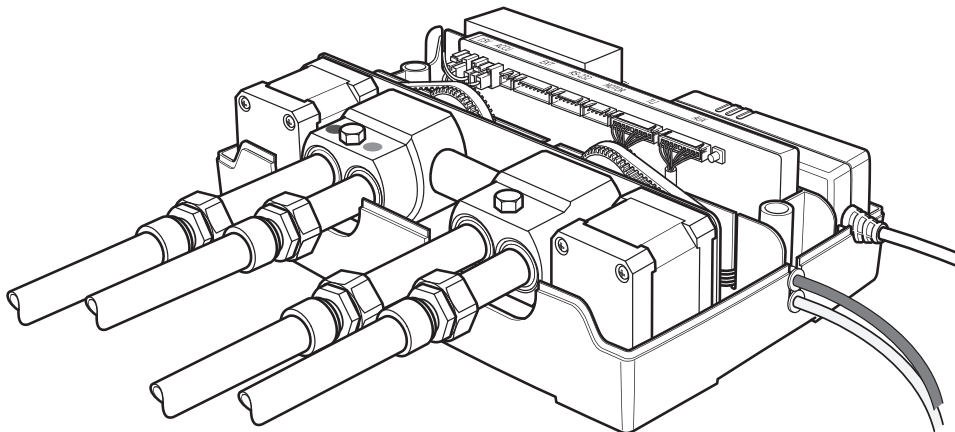
 The installed system should be operated to check for leaks.



 The installed system should be operated to check for leaks.

- 2 Open**
Push the **Smartview™** Interface once.
The TLC 30 FTD unit opens and the LED illuminates.

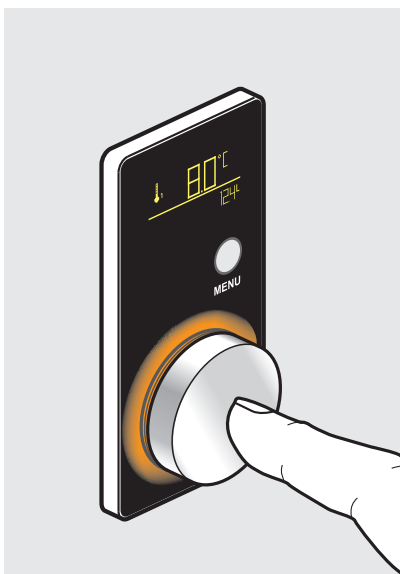

- 3 Close**
Push the **Smartview™** Interface again.
The TLC 30 FTD unit closes and the LED goes off.



SMARTVIEW™ TROUBLESHOOTING

ISSUE	PROBLEM	TROUBLESHOOT
The device does not function (i.e. the LED light is not on)	The AC adapter is not connected to the mains	Connect device to the mains power
	Mains power failure	Check household fuse box
	Back up battery not connected	Follow Step 18 on Smartview Installation Guide
	Vision wheel interface is not working	Follow Step 19-20 on Smartview Installation Guide
Device does not operate during a power failure	Battery not connected	Connect battery with controller (ACCU)
	Battery flat	Charge for at least 24hours. Follow Step 18 on Smartview Installation Guide
	Battery defective	Replace (replace every 3 to 5 years)
The water temperature does not match the indicated display	Hot and cold water connections reversed	Check connections are correct
	Hot or cold water stop valve closed or only half opened	Fully open both stop valves
	Kink in supply hose	Check connection hoses
	Connecting pipe blocked	Flush pipes and clean filter
	No hot water	Check hot water tank and instantaneous connections
	Temperature sensor defect	Carry out function «Self Check Diagnosis» on Smartview User Guide
	Difference in supply pressure between hot and cold water greater than 100kPa	Balance pressure to eliminate difference
Constant flow of water	Unit will not turn off	Carry out function «Self Check Diagnosis» on Smartview User Guide
The water shuts off before maximum run time has been reached	Flow sensor is defective	Carry out function «Self Check Diagnosis» on Smartview User Guide
The device is working but has no water flow	Motors are not calibrated	Carry out function «Self Check Diagnosis» On Smartview User Guide
	Stop valves closed	Open stop valves fully
	No water supply	Restore water supply
	Kink in supply hose	Check connection hoses
Interface flashes green	Cleaning mode active	Wait 45 seconds or deactivate via menu
The TLC 30 FTD is damp or wet	Inlet and outlets of TLC 30 FTD are not properly sealed	Inspect all connections, reseal if necessary
The vision wheel interface does not respond to temperature and flow adjustment	The interface elements are connected incorrectly	Follow Step 19-20 on Smartview Installation Guide
	The interface is defective	Carry out function «Self Check Diagnosis» On Smartview User Guide
	The knob is not running smoothly	Remove and clean knob

If issue persists or not covered by the above troubleshooting, please contact our Felton Technical Team on 1800 792 760 or enquiries@feltontapware.com.au

WARRANTY, MAINTENANCE & CARE

5-year warranty applies to all **Felton Digital** branded products including the electronic hardware and its components.

Where products are promoted as having a “5-year warranty”, Felton Industries Limited guarantees the electronic components of these products (excluding batteries) to be free from defects in materials and workmanship under normal installation, use and service for a period of five (5) years from the date of purchase. Fair wear and tear is expressly excluded.

This warranty is effective for five (5) years from the date of purchase and covers electronic replacement parts only (excluding batteries) and 2 years from the date of purchase for plumber’s labour relating solely to repairing or replacing the Hardware, provided the product is installed by a registered plumber. You must retain proof of purchase of the Hardware (such as an invoice or receipt) and proof of installation by a registered plumber and provide these to Felton on request.

This warranty is for manufacturing defects only and does not cover any damage to product due to abuse, negligence or improper installation. This warranty is given on the understanding that the product is installed by a registered plumber and operated according to Felton’s installation guide and the Australian/New Zealand standard AS/NZS3500. This warranty is provided to persons who are a “consumer” under the Consumer Guarantees Act 1993 only and for use in domestic/residential dwellings only (not for commercial use).

This warranty is subject to any other rights or remedies that you may have under the Consumer Guarantees Act 1993 (or any other applicable legislation) and to Felton’s Terms of Trade.

This **5-year warranty** does not cover:

- 1) any consumable items (e.g. batteries, filters, installation fittings) supplied with the products.
- 2) damage, problems or unsatisfactory performance caused to the electronic hardware by:
 - a. Faulty or incorrect electrical wiring, incorrect power supply, voltage fluctuations, over voltage transient spikes or electromagnetic interference not originating within the electronic hardware.
 - b. Incorrect or poor installation or application
 - c. Operation at conditions outside the operating conditions specified in the Felton Digital technical or sales data applicable to that electronic hardware.
 - d. Reconfiguration of the digital interface by the user – this is considered a service not a warranty.

For technical assistance please ring: 1800 792 760 or enquiries@feltontapware.com.au

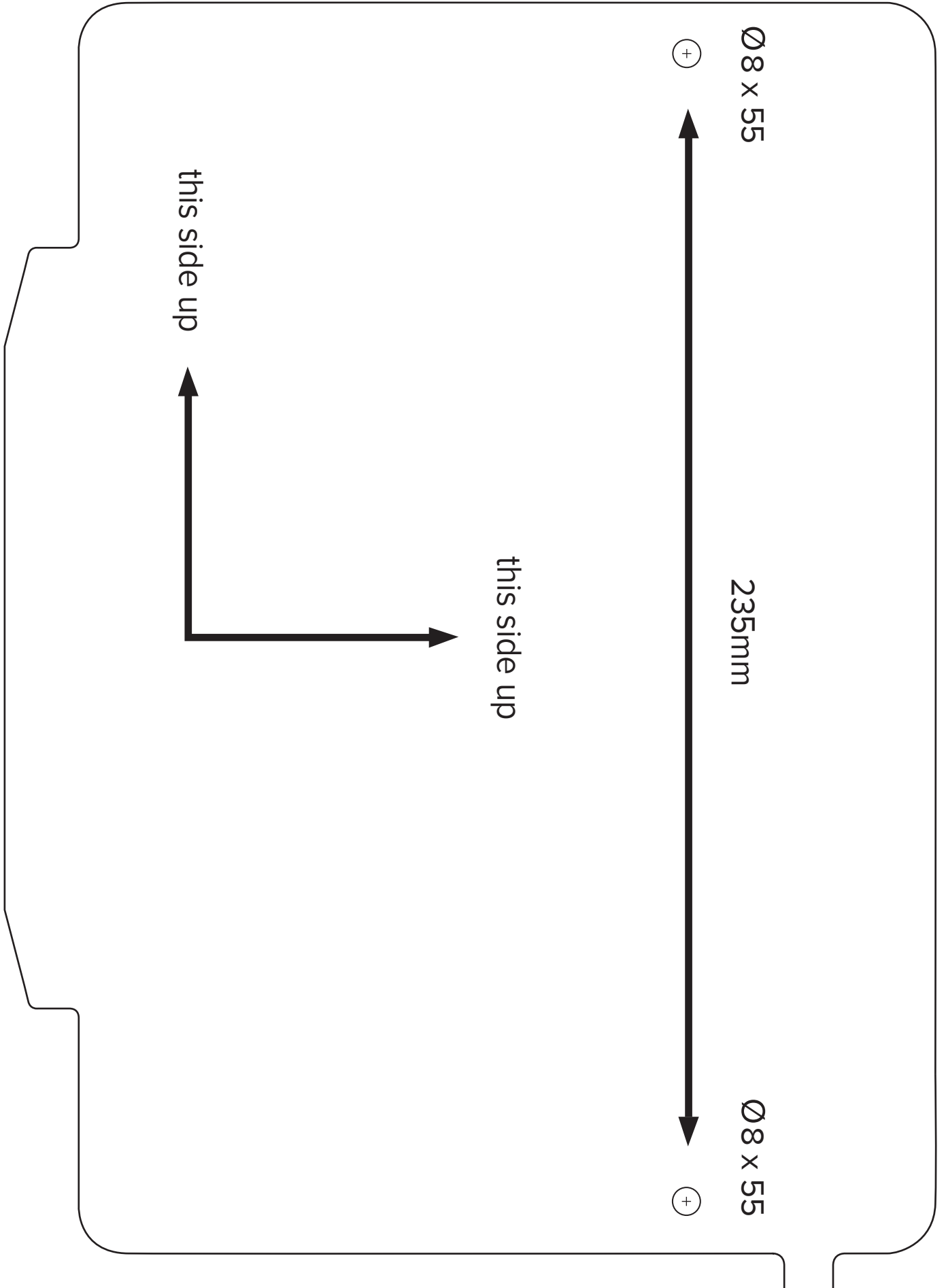



FELTON AUSTRALIA PTY LTD

PO Box 4191, Burwood East, Victoria, Australia 3151
1800 792 760



@feltontapware



/feltonltd



/FeltonIndustriesLimited



@feltonltd



/felton-industries-limited